

宋
Song + Associates

Architects • Planning • Interior Design

400 Amsterdam Ave. 8th Floor
New York, NY 10022
Telephone: 212-693-3422
Fax: 212-693-1422
AA - 0001165 EB - 0001095

Serial #:

Name: Thomas P. Kastner
License #: 0015877
Consultants:

The School District
of
Palm Beach County



WELLINGTON AREA
MIDDLE SCHOOL
02-JJ

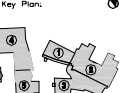

Revisions:

- 4-20-05 ADDITION #2
- 6-23-05 AS #1

Date: 3/1/05
S+A Proj. No: 03116
Owner Proj. No: 3371-8290
Drawn By: 9H/SH
Checked By: TK

Phase:
100% CONSTRUCTION DOCUMENTS

Sheet Title:
OVERALL SITE PLAN

Sheet #:
A0.0.2